



7 Manor View Close

Worthington, Ashby-De-La-Zouch, LE65 1RY

£850,000

A beautifully extended four-bedroom home centred around a spectacular open-plan kitchen, landscaped gardens and a stunning vaulted principal suite overlooking the countryside. Offered with no upward chain.

The Details

Deceptively spacious and exquisitely finished, this extended modern detached home redefines family living in the heart of Worthington. Thoughtfully redesigned and extended in 2025, it blends considered design, premium fixtures and uninterrupted indoor-outdoor flow all within a beautifully landscaped setting.

Step through the inviting entrance hall into a home that surprises at every turn. Understated yet striking, the interior palette of neutral tones and architectural panelling flows effortlessly throughout.

At the centre of this home is the show-stopping open plan living kitchen — a truly elevated space for modern family life. Granite worktops wrap the vast central island, complemented by a

- Beautifully extended modern detached home
- Stunning open-plan living kitchen with granite island & premium appliances
- Full-width bi-fold doors opening onto landscaped gardens
- Lounge with log burner
- All bedrooms generous doubles; two with built-in wardrobes
- Impressive vaulted master suite with dressing area & en-suite
- Garage with office/gym above, EV charger, extra side parking
- Quiet, friendly village of Worthington with Cloud Trail, pub & excellent school
- Offered with NO UPWARD CHAIN

Viewing

Please contact our Berkley Leicester Office on 0116 2544755 if you wish to arrange a viewing appointment for this property or require further information.

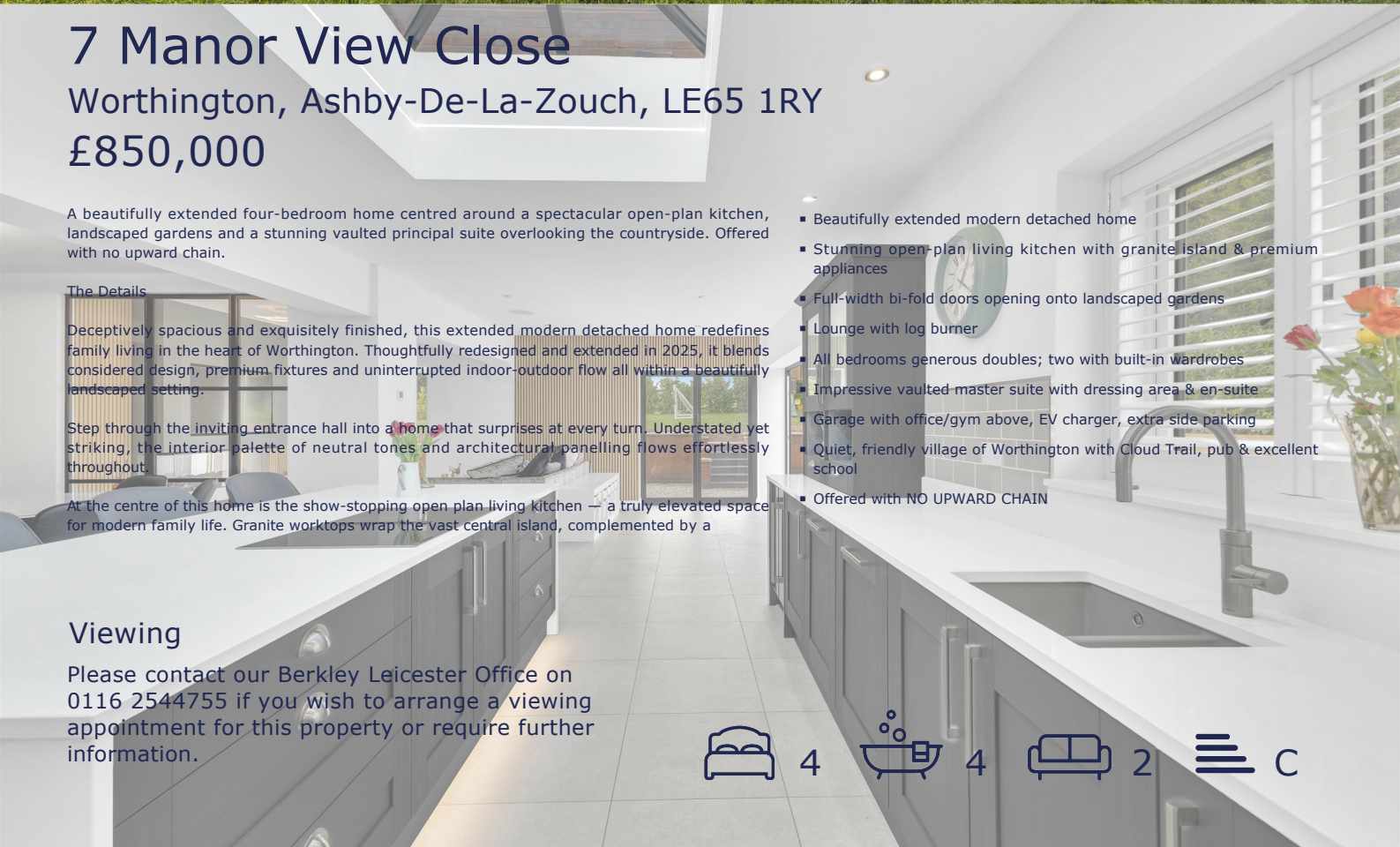

Floor Plan

Area Map

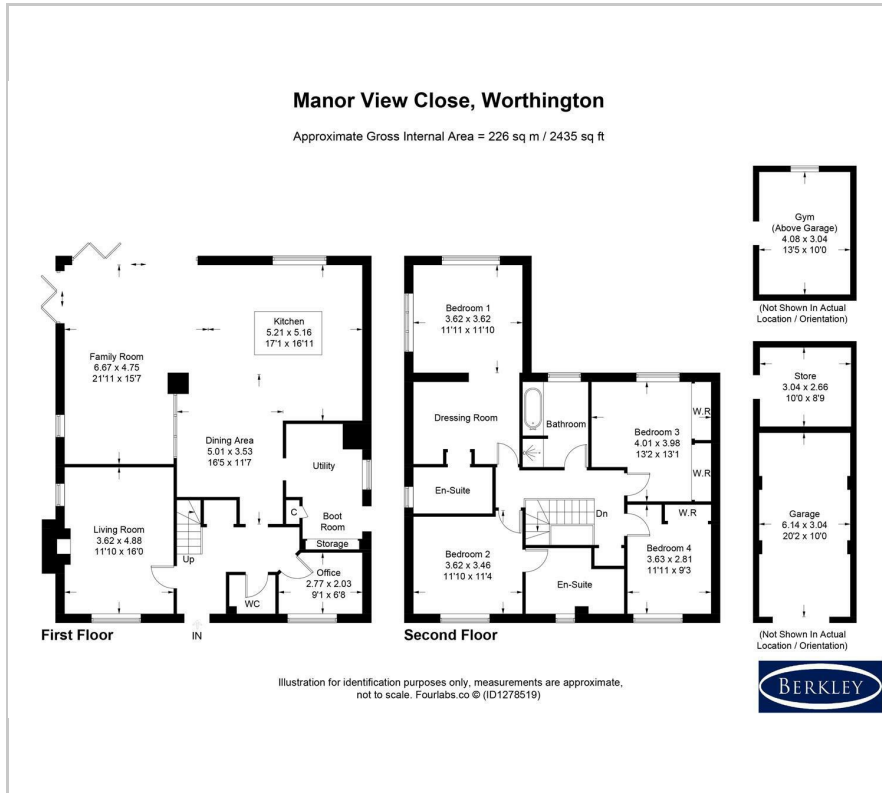

Energy Efficiency Graph

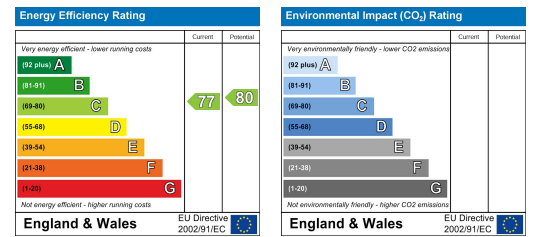

These particulars, whilst believed to be accurate are set out as a general outline only for guidance and do not constitute any part of an offer or contract. Intending purchasers should not rely on them as statements of representation of fact, but must satisfy themselves by inspection or otherwise as to their accuracy. No person in this firm's employment has the authority to make or give any representation or warranty in respect of the property.